

# HANDS-ON

## SUSPENSION INSTRUCTIONS

1.

Route the cables through the top cover.

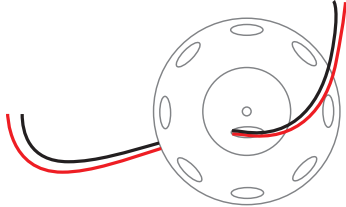

2.

In the P6, use the selector to choose your desired mode of operation and power tap. Strip the wires about 3 to 4 millimeters from the tip and mount the supplied connector. Insert the connector on the P6 and after fixing the buckle part, fit the cover in the P6 and with the supplied eye bolt and nut. Be sure to check that the eye bolt is properly and sufficiently inserted as it is through it that the P6 is suspended.

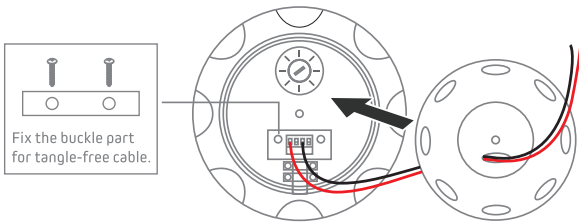

3.

Route the hanging cable through the eyebolt and using the two supplied carabiners secure the P6 to the structure.

**NOTE:** For faster and easier installation use the available Grippler accessories.

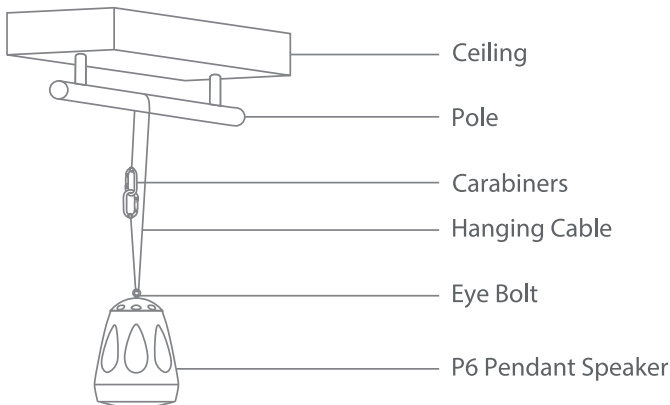

**WARNING:**

Make sure the speaker is properly secured to the structure, and the structure can handle the total weight suspended on it. Failure to do so may cause damage or injuries.

## WALL MOUNT INSTRUCTIONS

1.

Unscrew the rotation center screw to separate the plastic parts of the stand. Take care to not lose any small parts.

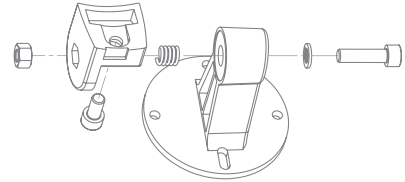

2.

Use the wall mount to mark the spots for the holes. Keep in mind that the adjustable stand cannot tilt the P6, it can only rotate up and down. Secure the wall mount to the wall with four screws.

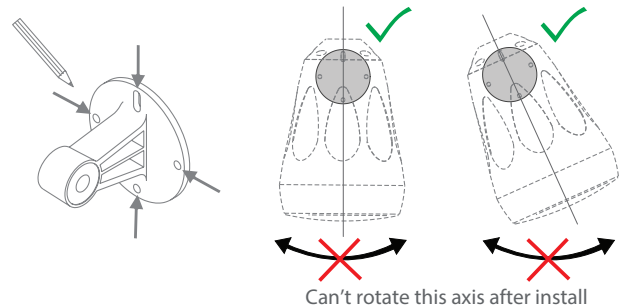

3.

Mount the speaker part of the stand on the P6. Connect the wires and screw the top cover supplied with the wall mount.

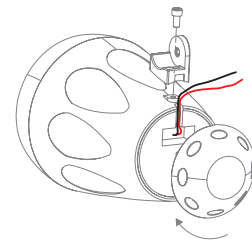

4.

Reassemble the stand with the P6 already attached and adjust as required.

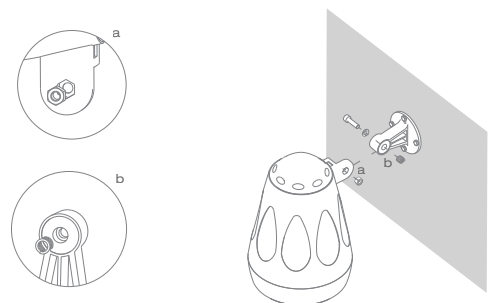

**NOTE:** The logo badge can be removed, from the grille, without damage.

# MÃOS À OBRA

## INSTRUÇÕES DE SUSPENSÃO

1.

Passar os cabos pela tampa superior.

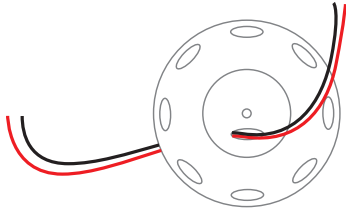

2.

Na P6, utilize o seletor para escolher o modo de funcionamento e a potência pretendidos. Descarte os fios cerca de 3 a 4 milímetros nas pontas e monte o conector fornecido. Insira o conector na P6 e depois de fixar a abraçadeira metálica com os parafusos, fixe a tampa na P6 com o parafuso de olhal e porca fornecidos. Certifique-se de que o parafuso está corretamente aplicado e suficientemente inserido, uma vez que é através dele que a P6 será pendurada.

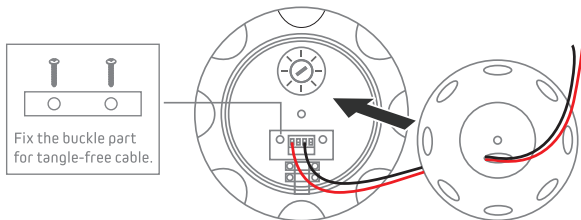

3.

Encaminhe o cabo de suspensão através do olhal e utilizando os dois mosquetões fornecidos prenda a P6 à estrutura.

**NOTA:** Para uma instalação mais rápida e fácil, pode utilizar os acessórios Gripple disponíveis.

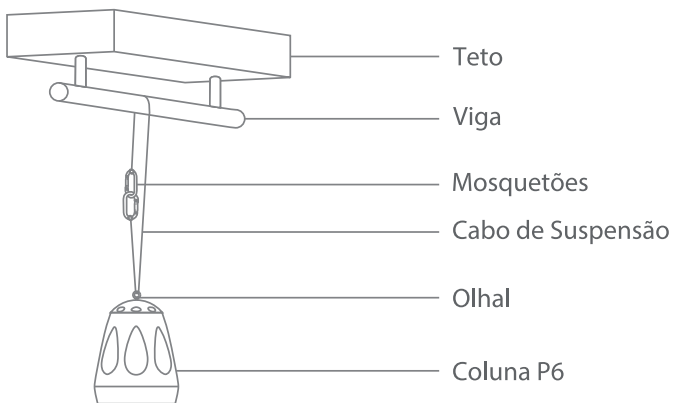

**AVISO:** Certifique-se de que a P6 está corretamente presa à estrutura e que a estrutura pode suportar o peso total suspenso. Existe o risco de causar danos materiais ou ferimentos graves caso falhe esta recomendação.

## INSTRUÇÕES DE MONTAGEM EM PAREDE

1.

Desaparafuse o parafuso central no eixo de rotação para separar as peças plásticas do suporte. Tome cuidado para não perder as peças pequenas.

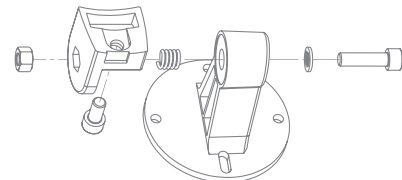

2.

Utilize o suporte de parede para marcar as posições para os furos. Tenha em mente que o suporte ajustável só pode ajustar a P6 num eixo, portanto confira a posição desejada com antecedência. Fixe o suporte à parede com 4 parafusos.

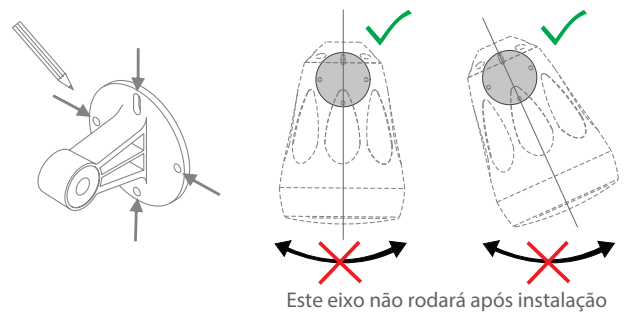

3.

Monte a peça do suporte correspondente à coluna na P6. Ligue os fios e aparafuse a tampa superior fornecida com o suporte.

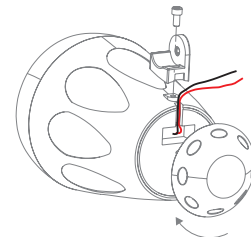

4.

Volte a montar o suporte com a P6 já fixa e ajuste conforme necessário.

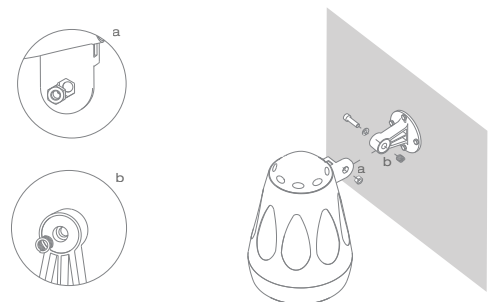

**NOTA:** O emblema do logótipo pode ser removido da grelha sem a danificar, se necessário.